



SARS-CoV-2

HEALTH & SAFETY PROTOCOL

MARMOTTA TROPHY

MARTELLTAL SKI MOUNTAINEERING RACE

20.02 & 21.02.2021

INTRODUCTION

The Marmotta – Martelltal Ski Mountaineering Race will take place on 20.02 & 21.02.2021.

The Marmotta Trophy is an important event for the tourist region and has a high national and international visibility.

The event is of great economic and touristic importance, which is one of the reasons for the local organising committee (LOC) and the ISMF to be interested in a safe and successful realisation.

The organiser of the event, LOC Martelltal, together with ISMF, and the regional health authorities, has set up a COVID-19 task force to minimise the risks during the pandemic.

The COVID-19 Task Force aims to plan and organise a safe competition event for all participants. The rules and guidelines are based on the national regulations and laws in Italy/South Tyrol.

These instructions and rules of the competition are designed on the basis of the current national and regional rules and regulations regarding COVID-19.

Changes are possible if necessary (due to changes in the decrees).

In order to minimise the spread of the virus, the Organising Committee has decided that neither spectators nor guests will be admitted to the competition venues and that no side events will be organised for the Marmotta Trophy 2021.

OBJECTIVES & AIMS

The health of the athletes, the staff, the volunteers and all other participants on site has the highest priority.

Protection from Covid-19 means taking responsibility- Responsibility for yourself as well as for others.

In the interest of the Community, it is a very clear civic duty to respect the rules in force and to be careful. Without this responsibility the massive spread of Covid-19 cannot be prevented.



It is therefore important to keep the minimum distance of 1 metre, cover your mouth and nose all the time it's necessary, observe the rules of hygiene, be vigilant and respect each other.

The LOC acts in solidarity and follows strictly the guidelines of the Autonomous Province of Bolzano and the Government of Italy. The containment and control of Covid-19 is a top priority.

The processes and rules of the concept should be clear and comprehensible. All participants have to strictly follow them, otherwise the accreditation will be revoked and the participants will be excluded from the event.

HEALTH & SAFETY PROTOCOLS

The following protocols were established by the Organizing Committee for the MARMOTTA TROPHY MARTELLTAL SKI MOUNTAINEERING RACE, working closely with the local health authorities!

- **Limit as much physical contact and interaction as possible by establishing sanitary bubbles**
- **A sealed off race area with very strict health and safety protocols**
- **Adhere to physical distancing protocols and protective measures everywhere**
- **Wearing a mask is required at all times, in every area (indoors and outside)**

All the coaches are required to properly inform their athletes and are engaged to supervise each participant and admonish compliance with the general protections measures in order to enable the safe development of the event.



GENERAL INFO

The whole event location will be equipped with the necessary safety devices (hand sanitiser dispenser, information signage...) **according** to the current legislation.

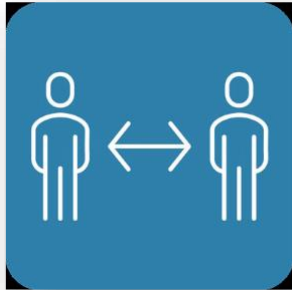

EVERYONE HAS TO ARRIVE AT VAL MARTELLO (MARMOTTA TROPHY) WITH A NEGATIVE RT-PCR TEST NOT OLDER THAN 48 HOURS (SEE ISMF COMMUNICATIONS & RULES)

AT THE ARRIVAL IN VAL MARTELLO (MARMOTTA TROPHY) EVERYONE HAS TO DO A RAPID ANTIGEN TEST IN THE COVID-19 TESTCENTRE BEFORE HE/SHE GETS THE ACCREDITATION AND CAN PROCEED WITH THE CHECK-IN IN THE HOTELS

GENERAL BEHAVIOUR

- If you are tested positive for Covid-19 and you still have no negative test result, please do not travel to the event venue! (the local health authorities make no distinction between a low or high CT-Value).

If you feel sick or you have any Covid-19 symptoms, do not travel to the event venue!



- Hygiene
 - Wash your hands regularly
 - Use the provided disinfection dispensers
 - Avoid handshaking
- Wearing a face mask is mandatory in all areas

The athletes must wear the mask until 60 seconds before the start of the race. At the arrival it is compulsory for the athletes to wear again the mask when entering the check material zone and to keep it always in any common site. A second mask must be carried in the backpack. The use of buff in place of a mask is not allowed.
- Avoid Contacts
- Direct contacts should be limited as much as possible
- Avoid any physical contact such as handshaking – non-physical greetings are highly recommended;
- Maximise distance between you and people from different “bubbles“
- The athletes have to warm-up on their own or only together with national teammates.

**After the Race: if any known Covid-19 symptoms appear contact our Health
Coordinator**

REPORTING OF SICKNESS DURING THE EVENT

- If you feel sick or have any Covid-19 symptoms, contact LOC COVID COORDINATOR
- Isolate yourself at the venue / in the hotel
- A rapid antigen test will be conducted
- Isolation until the test result
- In case of a positive test result further measures and tests will be coordinated by the LOC and the local health authorities



SARS-CoV-2 TESTING PROCEDURE

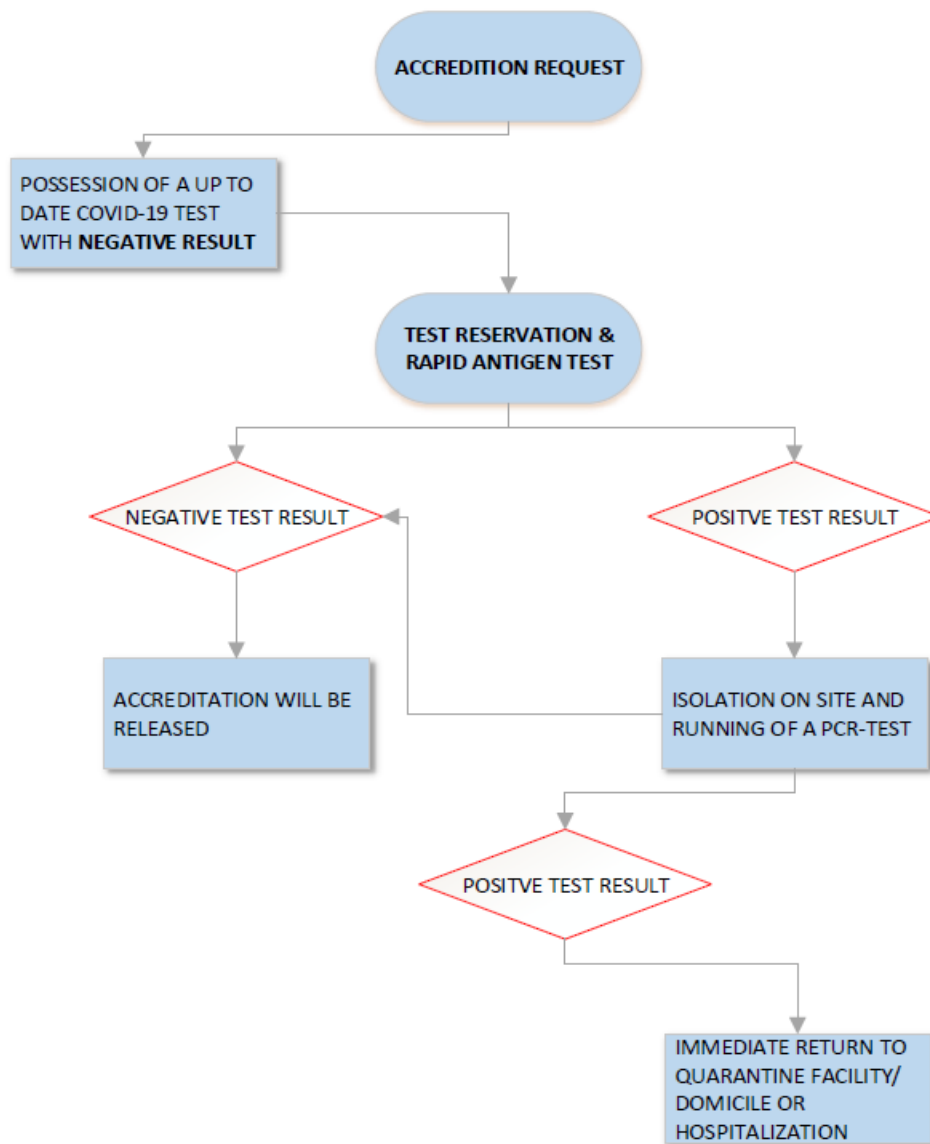

SARS-CoV-2 TESTCENTRE

Immediately after the arrival at Val Martello and BEVORE the check-in in the accommodation every person involved in the ISMF World Cup Marmotta Trophy has to a rapid antigen test in the Sars-Cov-2 Testcentre

Every team can book in advance a test reservation (covid@marmotta-trophy.it) or come immediately after the arrival, respecting the opening hours, to the testcenter

OPENING HOURS:

- Wednesday 17.02.2021
3.00 / 5.00 pm – Covid-19 Testcentre
- Thursday 18.02.2021
2.00 / 5.00 pm – Covid-19 Testcentre
- Friday 19.02.2021
4.00 / 7.00 pm – Covid-19 Testcenter

LOCATION: The Covid-19 Testcentre is in the National Park visitor centre CulturaMartell in the leisure centre Trattla.

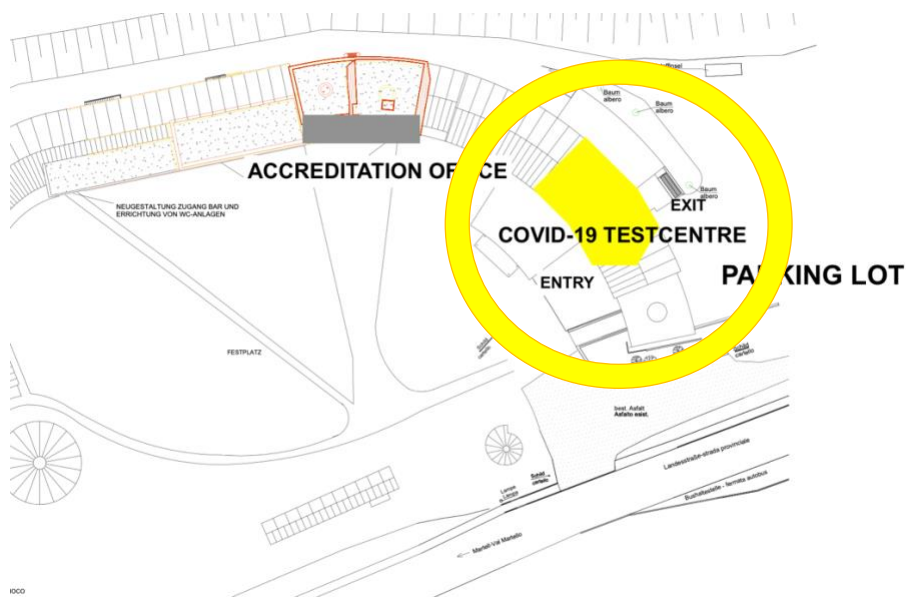

LOC COVID MANAGER – LUKAS INNERHOFER

phone: +39 331 / 67 23 912

e-mail: covid@marmotta-trophy.it



ACCREDITATION

- **The Accreditation Office is located at Kletterhalle Martell, Trattla, 39020 Martell (next to the Covid-19 Testcentre)**
- Access to the Accreditation Office only with a confirmed negative antigen test result.
- Only one person per team/group lines up and collects all accreditations
- Keep distance to others as much as possible
- Wear a face mask in-and outside the Accreditation Office
- Respect ways/paths and signage at the venue

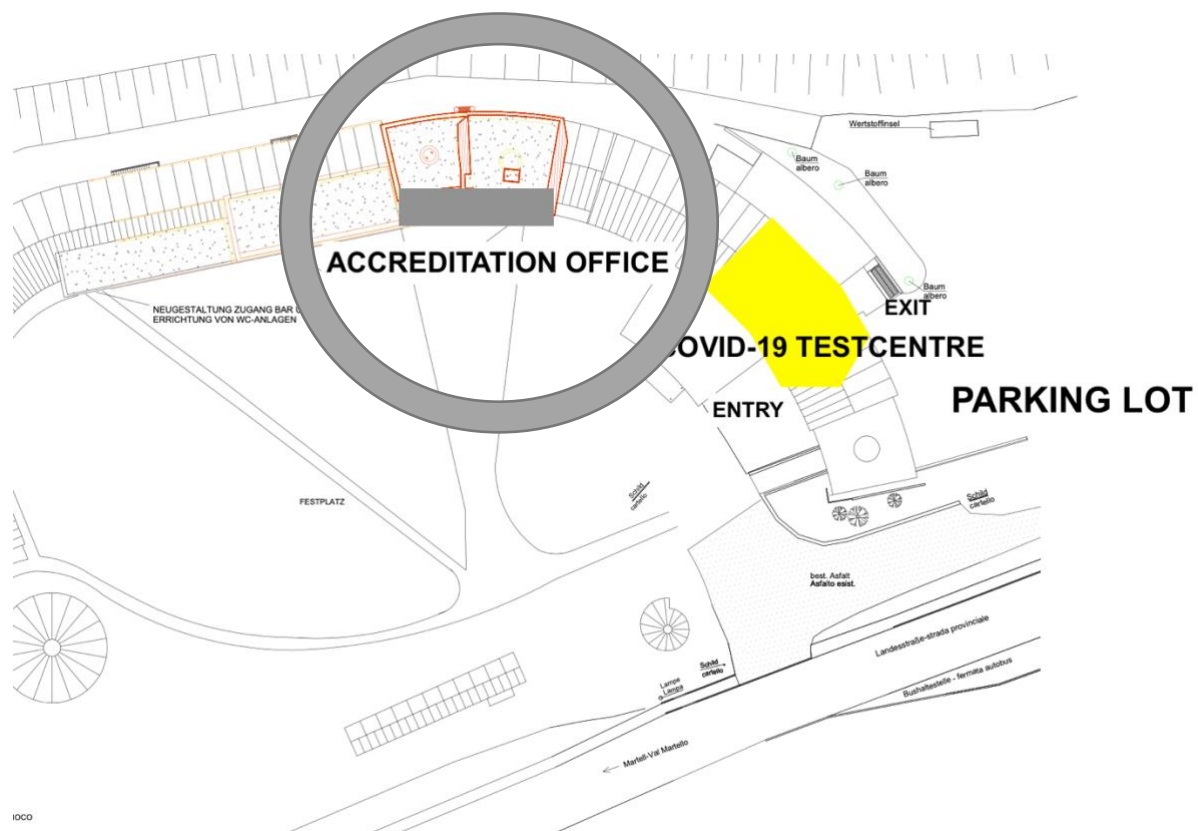

IN CASE SOME IS TESTED POSITIVE TO SARS-CoV-2 AND DOESN'T HAS THE POSSIBILITY TO GO BACK HOME IMMEDIATELY, WE HAVE A SMALL APARTMENT WITH 2 BEDROOMS, A KITCHEN AND LIVINGROOM AND A BATHROOM WHERE HE/SHE CAN STAY UNTIL THE RETURN BACK HOME. WE WILL PROVIDE THEM A SERVICE WITH FRESH GROCERIES.



For the Accreditation the LOC created different **Accreditation Areas** with different colors to guarantee the highest level of safety for all participants:

ACREEDITATION AREA:

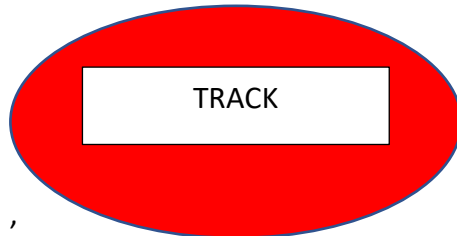

ACCESS ALLOWED TO: athlets, coaches, volounteers

“track”, TV team, photographers, LOC

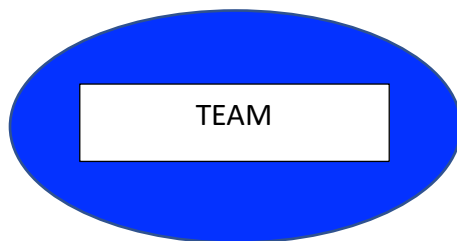

ACCESS ALLOWED TO: athlets, coaches, chaperons, LOC

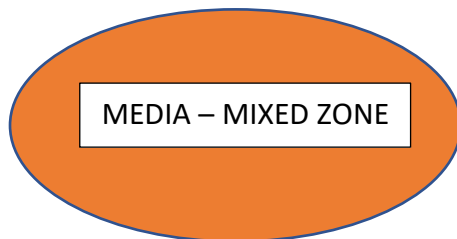

ACCESS ALLOWED TO: press, media, photographer, TV team, LOC



ACCESS ALLOWED TO: athlets, coaches, volounteers

“start/finsih”, TV team, chaperones, timekeeping, LOC



ACCESS ALLOWED TO: team leader, LOC



ACCESS TO ALL THE LOCATIONS AT THE VENUE IS ONLY POSSIBLE WITH THE CORRECT ACCREDITATION

A detailed plan of all the locations involved is shown here:

1. BIATHLON CENTRE "GROGG"

BIATHLON CENTRE | 2nd floor

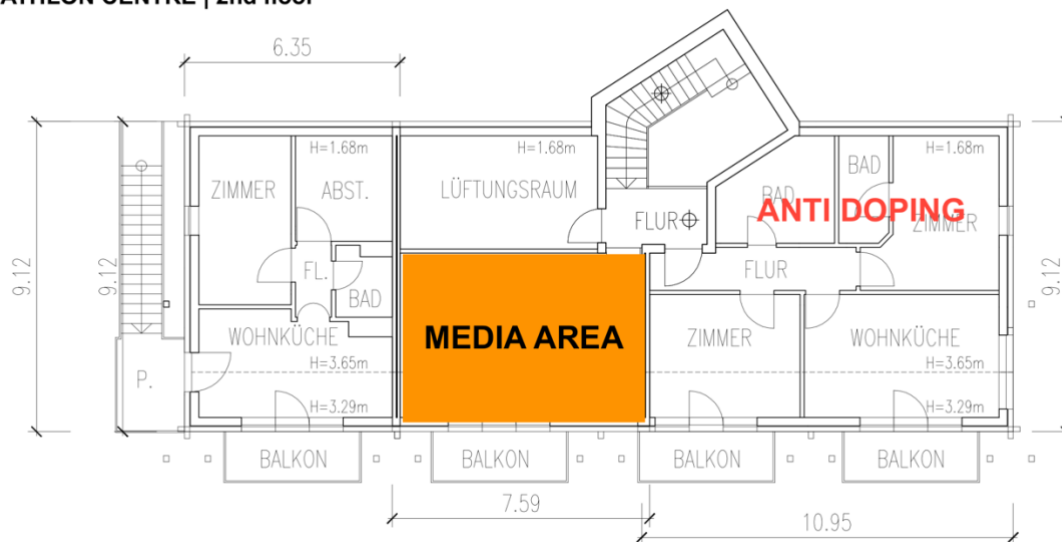

BIATHLON CENTRE | 1st floor

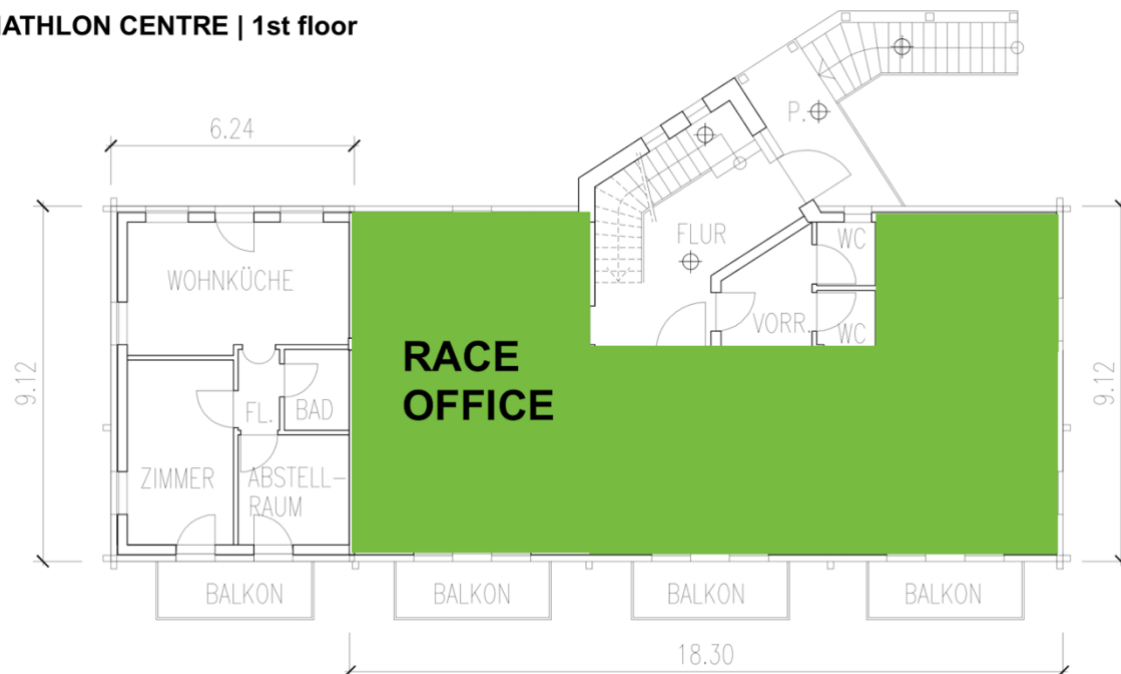

BIATHLON CENTRE | basement

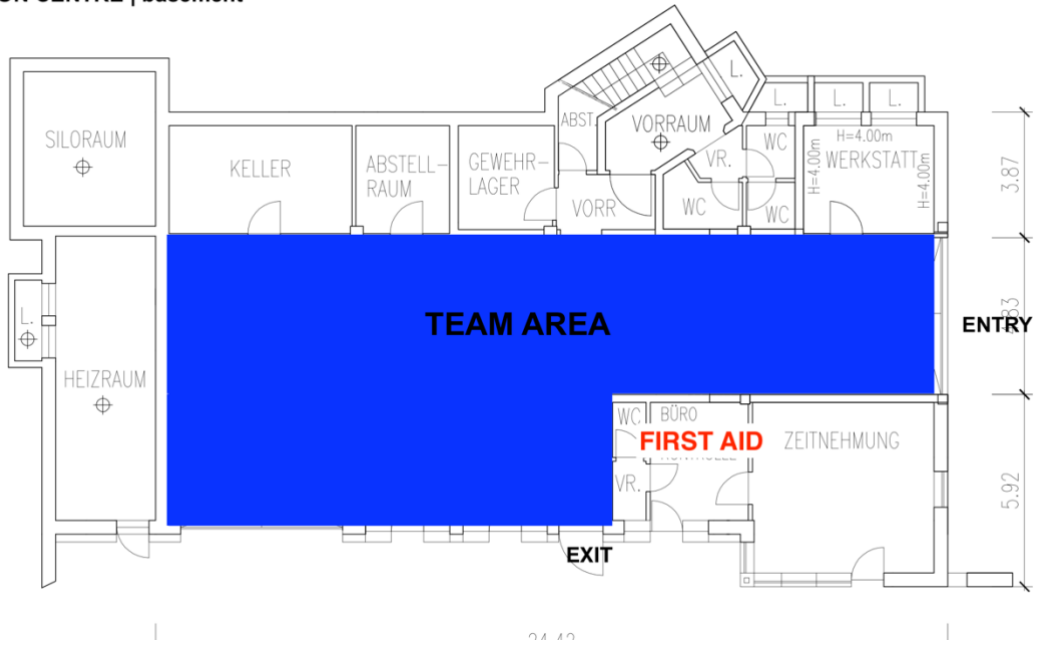

2. LEISURE CENTRE TRATTLA

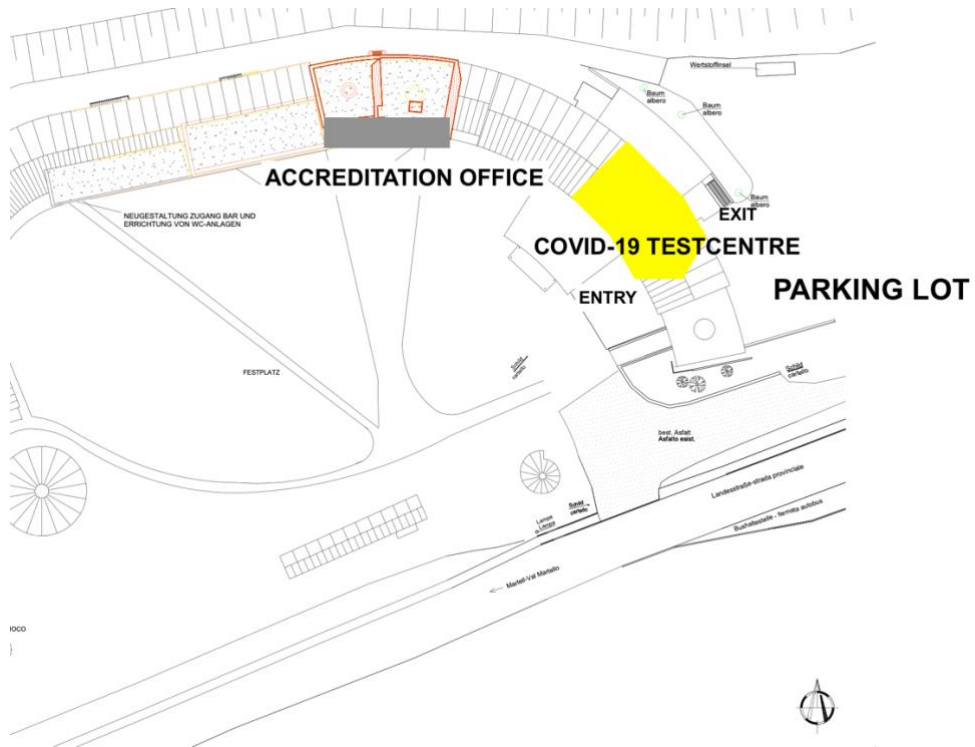

AT THE VENUE

- Keep distance to others as much as possible
- Respect ways/paths and signage at the venue
- Reduce time at the venue to a minimum
- Wear a face mask
- All areas will be delimited using fences to avoid contact between various groups, avoid unauthorized access and keep entries and exits separated
- „Act as you want others to act“

MEETINGS

- Meetings will be reduced to a minimum
- Meetings are held in the respect of the local Corona protocols and the appropriate distance measures
- Wear a face mask
- Team Captains Meeting
 - Will be organized with a limited number of people | only one person per team
- Press Conference after the Race –TBC

ACCOMODATIONS

- **Hotels will follow the National Health Regulations and try to adjust to the ISMF guidelines as well**
- Check-in at allocated hotel only after you've picked up the accreditation
- Try to stay separated from other hotel guests
- Review the circulation flow and distancing policy in common spaces
- No training in hallways



- Respect the hotel rules and general rules of hygiene

TEAM AREA

- Changing rooms for the athletes at the Sprint Race will be in the basement of the Biathlon Centre
- For each nation/team will be provided a Container next to the Biathlon Centre
- Changing rooms for the athletes at the Individual Race will be tents near the Finish Area (near the ex-hotel Paradiso)

RACE OFFICE

- Alcohol-based hand-gel arranged in all the locations;
- Hygiene & distancing signs across all the venues;
- Limited number of people in all areas;
- Organization of sanitification, cleaning and waste removal.

START & FINISH AREA

- Vertical Race: wide start area, in respect of the distancing rules;
- Sprint Race: mass start, distance of 1,5 m among athletes;
- Use of mask until 30 sec before the race; at the arrival it is compulsory for the athletes to wear again the mask when entering the check material zone and to keep it up to returning the hotel.
- A second mask must be carried in the backpack. The use of buff in place of a mask is not allowed;



PRICE GIVING CEREMONY & WINNER PHOTOS

- The flower ceremony will be held in the finish area immediately after the race
- The official prize giving ceremony will be held outdoors at the Biathlon Centre soon after the race
- Wear a face mask at all times
- Athletes must wear the mask at any ceremonies also when on the podium, pictures of the athletes will be taken with the mask on;
- athletes have to remain on own podium step.
- Keep the designated distance; no-handshaking;
- Trophies will be placed on the podium

MEDIA + MIXED ZONE

- Social distancing should be obeyed, movements should be limited
- No direct access to athletes; at least 2 metre distance in competition areas
- Face masks must be worn in all in-and outdoor areas, on-and off course
- Interviews must be conduct in in the finish area
- Photographers will not be able to enter the finish area to take photos of the ceremony
- The podiums will be placed in such a way that photos of the ceremony are possible from the photo stands
- Compliance with the ISMF guidelines



TRAVEL RESTRICTIONS

Latest information's regarding travel restrictions to and from Italy can be found at the following links:

<http://www.salute.gov.it/portale/nuovocoronavirus/dettaglioContenutiNuovoCoronavirus.jsp?lingua=english&id=5412&area=nuovoCoronavirus&menu=vuoto>

<https://infocovid.viaggiasesicuri.it/>

<http://www.provinz.bz.it/sicherheit-zivilschutz/zivilschutz/coronavirus.asp>

For further questions please contact: covid@marmotta-trophy.it

CONTACTS

- Main Contact for general enquiries
phone: +39 380 / 74 86 879
e-mail: info@marmotta-trophy.it
- Contact for on-site test related enquiries and in case of symptoms
phone: +39 331 / 67 23 912
e-mail: covid@marmotta-trophy.it
- Health Coordinator Dr. Patrick Franzoni and Lukas Innerhofer
e-mail (Dr. Patrick Franzoni): patrick.franzoni@sabes.it
e-mail (Lukas Innerhofer): covid@marmotta-trophy.it

PROTECT YOURSELF AND OTHERS – BE RESPONSIBLE!

We appeal to EVERYONE to act RESPONSIBLE and to keep and implement all measures and recommendations!



STAY SAFE

Appendix 1

QUESTIONNAIRE FOR ACCREDITED PERSONS

Name

Permanent address

Address at the event

Mobile telephone number

E-mail contact

Countries you visited in the last 14 days:

Have you had any cold symptoms (cough, runny nose, sore throat, difficulty, breathing) during the last 14 days?

- | | | |
|--|---------------------------|--------------------------|
| Fever | <input type="radio"/> YES | <input type="radio"/> NO |
| Chest pain | <input type="radio"/> YES | <input type="radio"/> NO |
| Headache | <input type="radio"/> YES | <input type="radio"/> NO |
| Nausea/Vomiting | <input type="radio"/> YES | <input type="radio"/> NO |
| Diarrhoea | <input type="radio"/> YES | <input type="radio"/> NO |
| Have you been in contact with someone with a proven infection with Covid-19? | <input type="radio"/> YES | <input type="radio"/> NO |
| Have you been in quarantine during the last 14 days? | <input type="radio"/> YES | <input type="radio"/> NO |
| Have you tested negative to the PCR (Polymerase chain reaction) or Antigen test within 72 hours before entering the Event Country? | <input type="radio"/> YES | <input type="radio"/> NO |

The relevant result certificate has to be presented upon the arrival at the venue location together with this questionnaire

